

1 of 4



NOVEMBER 30, 2016

Gensler New York Moves Into Smart Office

NEW YORK – Gensler has relocated its 600+ employees to 1700 Broadway after more than 25 years in Rockefeller Center.

The Environment

Gensler's designers converted the office into an architecturally significant space with elements that add up to a new way of working. Gensler occupies 120,000 square feet in the Theatre District, taking up the second through the sixth floors of a 42-story office tower on Broadway between 53rd and 54th streets, allowing for the firm's continued growth.

The lower levels of the building provide a dynamic vantage down Broadway, bringing a street-level energy into the space. According to local news outlets, the move signifies a larger real estate trend of "Midtown's increasing appeal to creative tenants."

An agile floorplate became an opportunity for the firm to build creative communities on each floor. They're linked together by an internal staircase, which is surrounded by collaboration and meeting spaces.

The most dramatic branded moment is the 20-foot marquee that marries digital design with traditional signage. One side of the marquee features a LED screen with generative design and ambient graphics that are activated by people moving throughout the space.

On the fifth floor, Gensler created a new design center that melds a traditional library function with the firm's technical specifications team. This allows designers to access building materials, technical expertise and inspiration all at the same time.

The ratio of collaboration spaces and heads-down workstations was directly influenced by a key finding from Gensler's 2016 Workplace Surveys. The research shows that innovative employees have choice over when and where to work. In an effort to maximize innovation and creativity, the design includes an abundance of amenities, conference rooms and specialized meeting areas. The workplace features sit-stand desks and a bike room to encourage health and wellbeing; a digital lab, model shop, design center, visualization theatre, work cafés, and "collaboration avenues" – flexible spaces that celebrate and enable the design process.

The Smart Office

Building on the 2016 Workplace Survey finding that the most innovative companies invest in the individual, the firm implemented smart systems to monitor how each employee interacts with the workplace. The system uses first-in-class sensor and analytics platforms that speak to the firm's long-term sustainability goals, while improving the comfort of workspaces and the efficiency of the employees who work in them. An "Internet-of-Things" system shares information on the movement of people, informing designers on how people are utilizing their desks, conference rooms and collaboration areas.

In addition, a supplement system measures and actively detects conditions of the environment – CO2 levels, temperature and daylight – and makes intelligent decisions in real time. An air cleaning system releases positive and negative ions into the supply air ducts, removing harmful particulates and improving indoor air quality.

"Broadway serves as a lifeline running through our city, knitting together the unique fabrics that make up New York – it could be called the most iconic street in the world," said [Rocco Giannetti](#), Co-Managing Director of Gensler's New York office. "Our future is multi-dimensional and we sought a location that celebrates that."

The move was led by Gensler's Managing Directors [Rocco Giannetti](#) and [Julia Simet](#) and Regional Managing Principals [Robin Klehr Avia](#) and [Joseph Brancato](#). CBRE's Mary Ann Tighe, Ken Rapp, Timothy Dempsey and Sinclair Li represented the move.

Interviews available upon request.

Contact

Erin Ryder
erin_ryder@gensler.com
 +1 212.492.2614

RELATED CONTENT

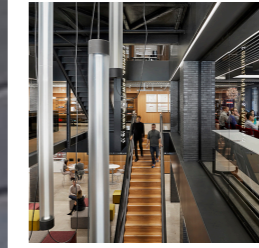

PROJECT
Gensler New York
 Playing off the Theater District setting of their new...

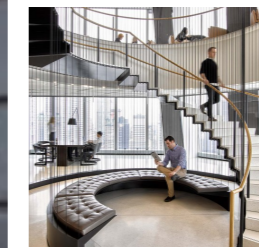

PROJECT
Condé Nast
 In a transformational design and fit-out over 25...

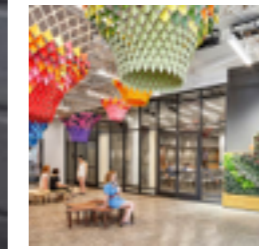

PROJECT
Etsy
 Blurring the lines between workplace and habitat...

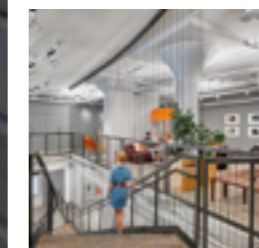

IN THE MEDIA
Architectural Record
 Carroll and Briefel discuss Gensler's design for Etsy...

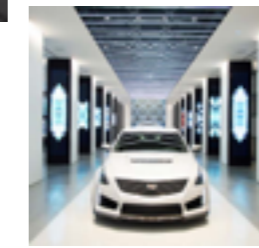

IN THE MEDIA
Glossy
 Cadillac has a "cool new spot in SoHo" that connects to...



DIALOGUE ARTICLE
Workplace Now
 New pressures on their teams are leading organizations...



GENSLER RESEARCH INSTITUTE
U.S. Workplace Survey 2016
 Today's organizations value Innovation, creativity and...

OFFICE

New York
 1700 Broadway, Suite 400
 New York NY 10019
 Phone: +1 212.492.1400